

Café Nearby

Soba Café SCHOLA



The new school building has been turned into a cozy café. You can enjoy freshly made soba or Breton Galette (savory French pancakes) that have been made from locally-grown buckwheat. Their homemade cakes are also recommended.



O: 11:00-15:00 / Tue-Sat
T: 080-6657-3381
A: Miyamae 1374, Kuimaru,
Showa, Onuma-gun



Facebook



Showa village
Tourism Promotion Division
T: 0241-57-2124
A: Miyamae 1374, Kuimaru, Showa,
Onuma-gun, Fukushima, 968-0212

Instagram



Tourism & Community Center



Showa village, Fukushima

Open: 9:00-17:00
Closed: 12/29-1/3

About Kuimarusho

Former Elementary School

Kuimarusho is a community center and a tourist attraction located in Showa Village. This nostalgic, 80-year-old wooden building used to be an elementary school wherein, at its peak, over 100 children once attended. The school was closed due to depopulation in the area in 1980.



Before Renovation

Escaping Demolition

The building originally had plans to be demolished however it was saved by two people. Firstly, by the anthropologist **Prof. Masao Yamaguchi** who, from 1992 through to 2006, used this building to hold symposiums, workshops and concerts. It was because of



Prof. Yamaguchi at Kuimarusho

these activities that the demolition was put on hold. And secondly, by the film director **Takushi Tsubokawa**, who fell in love with the school and decided to shoot the movie *Hameln* there starting in 2009. After the end of the shooting in 2012, the locals began to hold an annual autumn festival named *Ichō-matsuri* (gingko-festival) in the schoolyard. After the movie's release in 2013, the villagers were inspired to begin a signature-collecting campaign against the demolition.



Shooting of "Hameln"

With the Ginkgo Trees

In 2015, the village office decided to preserve the building. Renovation work commenced in 2017 and was partly funded through crowdfunding. After the grand opening in May 2018, the building has become popular not only among locals but also among tourists as a photogenic place, home to two old ginkgo trees that in the autumn are surrounded by a brilliant golden carpet of fallen leaves.



Rooms can be rented hourly / daily.
For further information, please ask staff.

Floor Plan



1. Music Room: rental room with AC, a vintage organ and projection screen

- Ginkgo trees through the windows



2. Class Room: historical recreation of the classroom

- Nostalgic atmosphere of the class room



3. Library: rental room

- Paintings made by students at their time of graduation

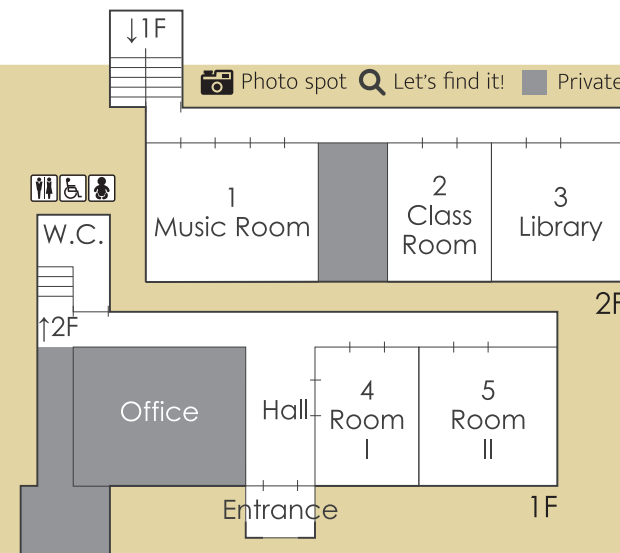

4. Room I: rental room with AC & kitchenette

- Student paintings
- Work schedule of teachers



5. Room II: rental room with AC

- A board on which "How to study" is written on.



Did you know...?

The two Ginkgo Trees in the schoolyard are over 120 years old and are named *Baucis* and *Philemon* by Mr. Tsubokawa inspired by a kind couple in a fable of Greek mythology.

The name "Kuimarusho" comes from *kuimaru* which is the name of the district and *sho*, an abbreviation of *shōgakkō*, which means "elementary school".

Pillar Joints:

Some of the pillars were rotten around the base at the time of the renovation work. These areas were removed and were then spliced together with new pieces of wood without any metal bolts.

Can you find...?

Wavy Window Glass: Some of the windows are left from before the renovation. They can be distinguished from the new ones by their wavy surface.